

REV.	ECN NO	LOCATIONS	DESCRIPTION	DATE	REVISER	APPD
A.0			New Product	101110		

RoHS Compliant

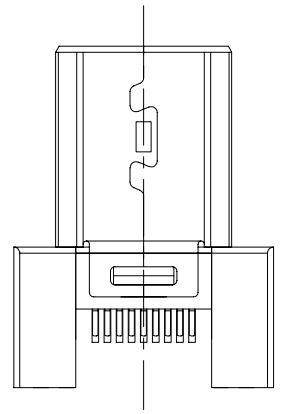
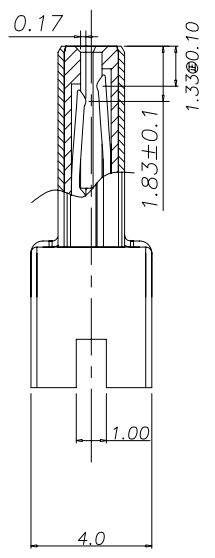
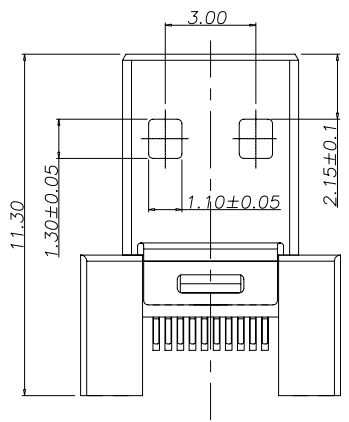
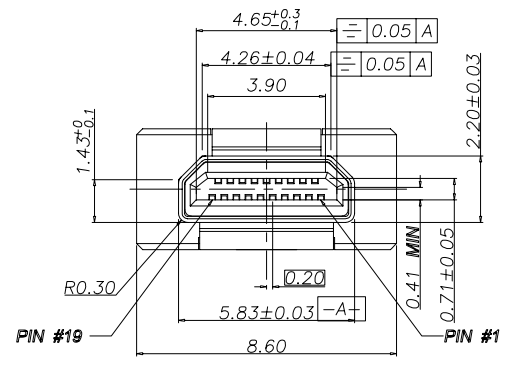

- NOTE:
1. Electrical
 - 1.1. Rated Voltage: 40V AC maximum
 - 1.2. Rated Current: 0.3A min.
 - 1.3. Withstanding Voltage: 150V AC/1 minute,
 - 1.4. Insulation Resistance: 150V DC 10MegaOhms min.
 - 1.5. Contact Resistance: 30MiniOhms Max.
 2. Mechanical
 - 2.1. Insertion Force Max: 4.4kgf max.
 - 2.2. Withdrawal Force Min: 0.5kgf min. , 2.5kgf max.
 - 2.3. Durability: 5000 cycles at 100±50 cycles perhour, Contact change from initial value: 30miniOhms Max.
 3. Plating
 - 3.1. Terminal:
 - Contact area: 1u" gold plate over 50u" NI min.
 - Solder area: 100u" pure TIN plate over 50u" NI min.
 - 3.2. Shell: G/F" GOLD PLATE OVER 100u" NI
 4. Environmental:
 - Operating Temperature: -25°C To +85°C

PART NAME	Material	QT'Y	NOTE
SHELL	BRASS	1	G/F" GOLD PLATE OVER 100u" NI
18Pin TERMINAL	C5191	18	CONTACT AREA: 1u" GOLD PLATE OVER 50u" NI min. SOLDER AREA: 100u" PURE TIN PLATE OVER 50u" NI min.
1Pin TERMINAL(Short)	C5191	1	CONTACT AREA: 1u" GOLD PLATE OVER 50u" NI min. SOLDER AREA: 100u" PURE TIN PLATE OVER 50u" NI min.
HOUSING	LCP	1	BLACK, UL 94-V0

MODEL NO:				
MATERIAL: See Note		COLOR:		
UNIT: mm	SAZE: A4	Q'TY:	PART NAME: HDMI D-TYPE 19P W/O PCB FOR CABLE ASSM' Y	
TOLERANCE UNSPECIFIED		DRW: Johnson	PRAT NO: HDD-M-CN04	
.X ±0.30	.XX ±0.20	CHK: LUCKY	DWG NO:	
.XXX ±0.10	ANG ±1°	APP: LUCKY	SCALE: 1:1	
		SHEET: 1 of 1		REV. A.0