

RoHS Compliant

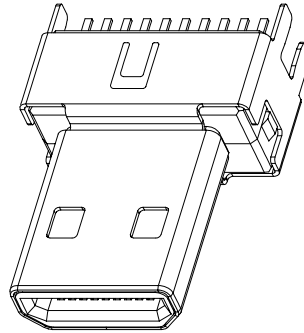
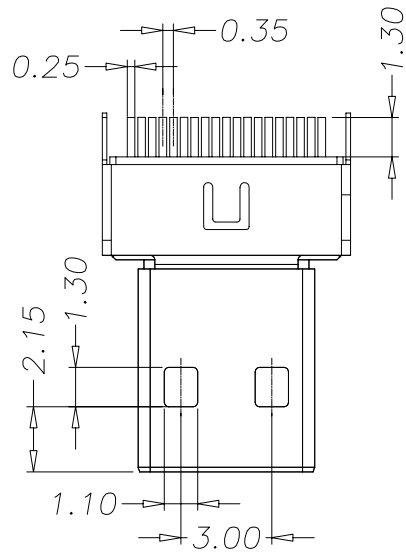

SPECIFICATION

*ELECTRICAL

- 1.CONTACT RESISTANCE:
30mΩ MAX.
- 2.DIELECTRIC WITHSTANDING VOLTAGE:
500V AC MAX.
- 3.INSULATION RESISTANCE: 100MΩ MIN.
- 4.RATE CURRENT: 1.5A.

*MECHANICAL

- 1.INSERTION FORCE: 4.5kg maximum
- 2.EXTRACTION FORCE:0.5(kg)MIN.

*MATERIAL

- 1.HOUSING:THERMOPLASTIC, LCP
GLASS FIBER FILLED, UL 94V-0 RATED.
- 2.CONTACT:COPPER ALLOY C5210
- 3.SHELL:SUS304R-1/2H, PLATING Au OR Ni

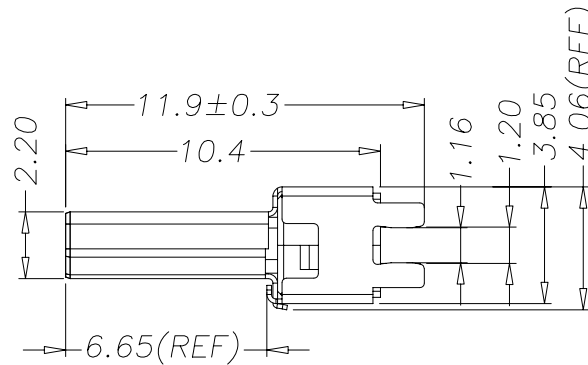
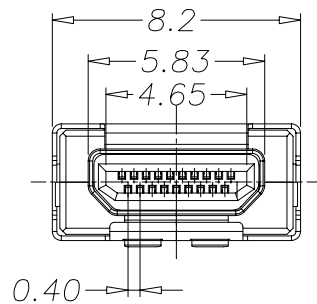

PART NO. INFORMATION

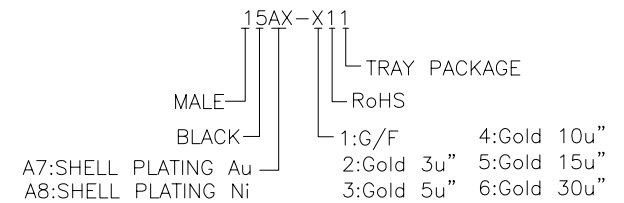

| | | | | | | |
|---------|-----|----------|-------------|---------|----------|----------|
| ECN. NO | REV | DATE | DESCRIPTION | CHANGED | APPROVED | UNIT: mm |
| | A | 12.02.25 | RELEASE | | | |

| | | | | |
|---------------|-------------------|--------------|--|-------|
| ▼ = Places | TOLERANCES UNLESS | | | |
| | X. ± 0.50 | X.° ± 3' | | |
| DIM NO. Ⓢ | .X ± 0.25 | .X° ± 2' | DESIGN: Jenny | DATE: |
| SCALE: 1:1 | .XX ± 0.15 | .XX° ± 1' | CHECKED: | DATE: |
| SHEET: 1 OF 1 | .XXX ± 0.10 | .XXX° ± 0.5' | APPROVED: | DATE: |
| | | | | |
| | | | HDMI D TYPE 夹板式公头 PART NO: HDD-M-CN03 SIZE: A4 DWG NO: REV: A | |