

RoHS Compliant

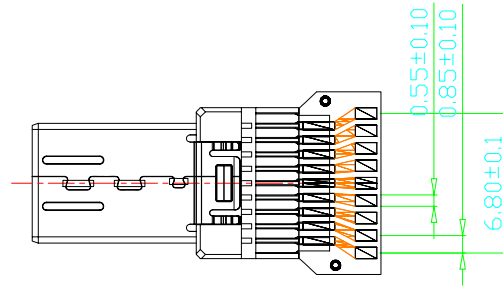
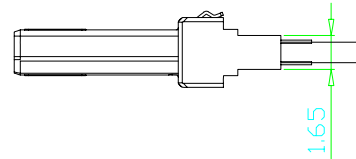
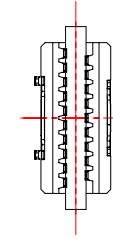
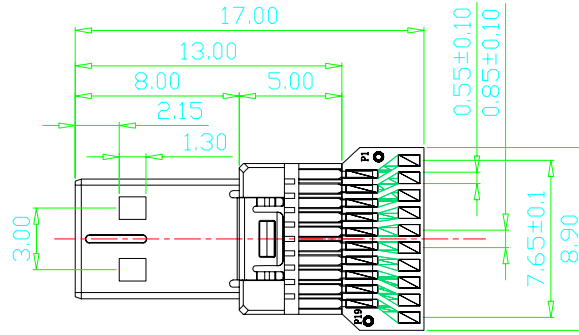
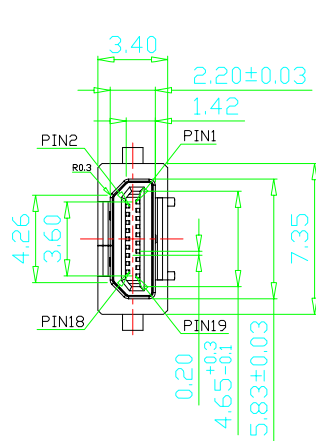

NOTES:

1. CONTACT RESISTANCE : 30 MILLIOHMS MAX.
2. DIELECTRIC STRENGTH : 500 VAC MIN.
3. INSULATION RESISTANCE : 100 MEGOHMS MIN.
4. OPERATING TEMPERATURE : -20°C TO +85°C.
5. UNDERPLATING : NICKEL ALL OVER.
6. OPERATING FORCE:
 - 6.1 INSERTION FORCE: 44.1N {4.5kgf} MAX.
 - 6.2 WITHDRAWAL FORCE: 5N MIN. 25N MAX.

PART NO. INFORMATION

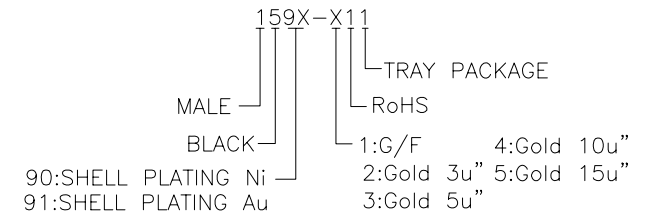

NO.	PART NAME	MATERIAL	MANUF ACTURE TYPE & FINISH	QTY	REMARK
1	SHELL	SUS	GOLD PLATED OR Ni PLATED	1	
2	HOUSING	LCP	COLOR:BLACK	1	UL94V-0
3	PCB脚			1	
4	CONTACT	COPPER	TIN /GOLD PLATED	19	

ECN. NO	REV	DATE	DESCRIPTION	CHANGED	APPROVED	UNIT: mm
	A	10.12.20	RELEASE		JESSE	

▼ = Places

DIM NO. Ⓢ =

SCALE: 1:1

SHEET: 1 OF 1

TOLERANCES UNLESS

X. ± 0.35	X.° ± 3'
.X ± 0.30	.X° ± 2'
.XX ± 0.20	.XX° ± 1'
.XXX ± 0.10	.XXX° ± 0.5'

BossConn

DESIGN: _____ DATE: _____

CHECKED: _____ DATE: _____

APPROVED: _____ DATE: _____

Jesse Zhou 11.6.10

**HDMI D TYPE PLUG
SOLDER TYPE WITH PCB 9#4**

PART NO: HDD-M-CN02 SIZE: A4

DWG NO: _____ REV: A