

REV.	ECN.NO.	DATE
A	RELEASED	05/23-'23

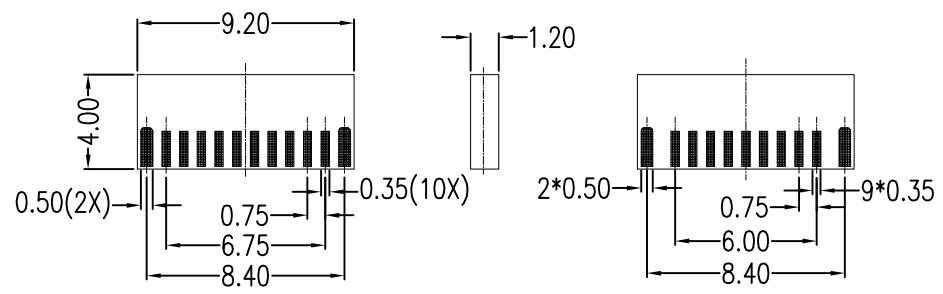
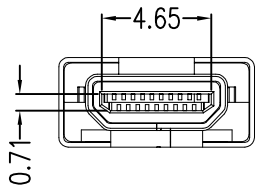
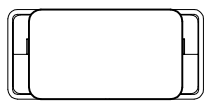
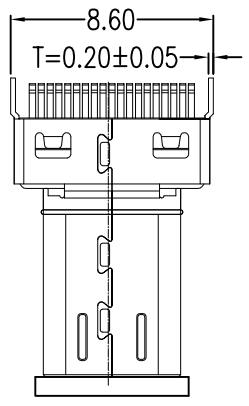
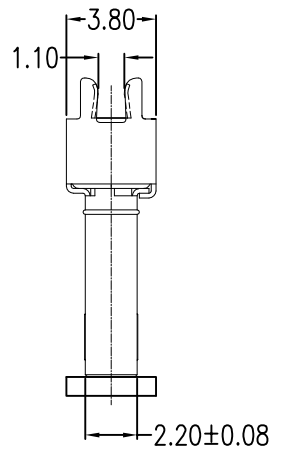
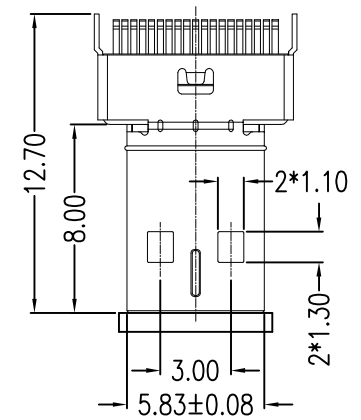
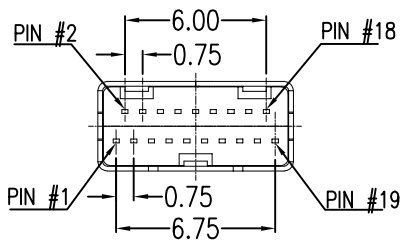

RECOMMENDED PCB LAYOUT
(THICKNESS=1.20±0.05mm)

NOTES:

*Material

Housing: LCP, UL 94V-0 Rated; Color: Black.
Shield: Brass.
Plating: Plated Over 50u" Ni min.
Contact: C5191.
Plating: Contact Area: Gold Plated Over.
Soldered Area: 100u" Mist Tin Plated Over 50u" Ni Min.

*Mechanical

Insertion Force Max: 4.5kgf max.
Removal Force Min: 0.5kgf min. , 2.5kgf max.
Durability: 5,000 cycles at 100±50 cycles per hour.

*Electrical Specification

Rated Voltage: 40V AC/DC maximum.
Rated Current: 0.3A max.
Dielectric strength: 150V AC/1 minute
Insulation Resistance: 150V DC 10MΩ min.
Contact Resistance: 30mΩ Max.

*Environmental

Operating Temperature: -20°C to +85°C

*How to order:

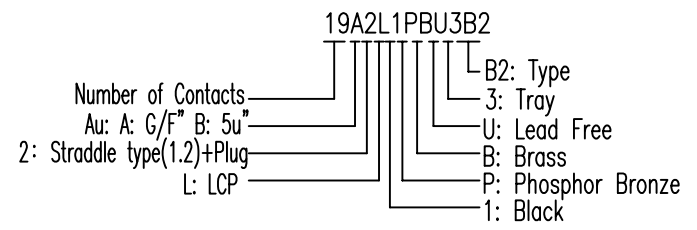

REV	Units		mm	Scale	3:1	Drawing By	Date	BossConn Electronics			
	Tolerance Unless Otherwise Specified		.X	~	±0.38	Reviewed By	Date				Date
			.XX	~	±0.25	Approval By	Date	Sheet	1 of 2	Title	HDMI D TYPE MALE STRADDLE MOUNT TYPE (夾板1.20mm) + 過爐塞子
			.XXX	~	±0.20			Third Angle Projection	Drawing No.		
			Angle	~	± 3°						

